



Freehold
5 Bedroom Double Fronted Semi Detached House

£1.3M

Wilmer Way,
Southgate N14

Specifications

This spacious property has fabulous views over Broomfield Park and is located within easy reach of Palmers Green British Rail, shops and Arnos Grove Underground Station. Also situated near Southgate "The Green" with its shops and restaurants.

Newly refurbished
Five double bedrooms
Four bathrooms
Spacious through lounge
Open plan kitchen diner
Additional reception room
Excellent transport links
Chain free









Floor Plans

Denotes restricted head height

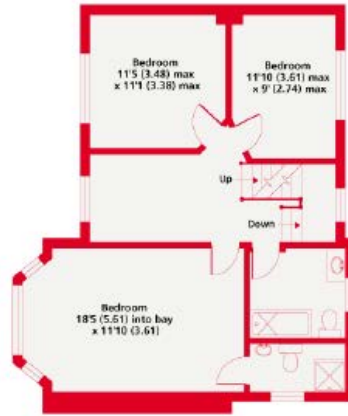

First Floor

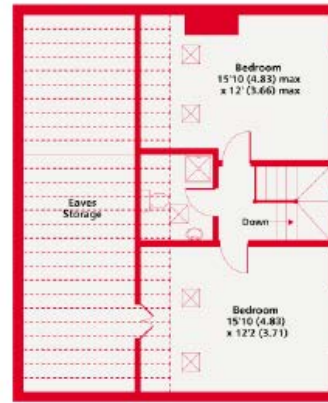

Second Floor



Ground Floor



Wilmer Way



BTH Properties

PROPERTIES



info@bthproperties.co.uk
+44 (0)20 3865 1239
bthproperties.co.uk